

NZ 28/05 SOUTH PACIFIC OCEAN - Samoa Islands - Western Samoa Westwards - Tavinui Bank South-Eastwards - Depth.

Chart NZ 14052 (INT 52) [93/04]

Substitute depth 21 for depth 26 12° 34'.00S., 174° 19'.00W.

Chart NZ 14060 (INT 60) [26/05]

Substitute depth 21 for depth 26 12° 34'.00S., 174° 19'.00W.

Chart NZ 14061 (INT 61) [179/04]

Substitute depth 21 for depth 26 12° 34'.00S., 174° 19'.00W.

Chart NZ 14605 (INT 605) [55/04]

Substitute depth 21 for depth 26 12° 34'.00S., 174° 19'.00W.

Chart NZ 14606 (INT 606) [178/04]

Substitute depth 21 for depth 26 12° 34'.00S., 174° 19'.00W.

Chart NZ 14629 (INT 629) [120/02]

Substitute depth 21 for depth 26 12° 34'.00S., 174° 19'.00W.

Chart NZ 14631 (INT 631) [41/04]

Substitute depth 21 for depth 26 12° 34'.00S., 174° 19'.00W.

UKHO Notice 4422/04
 NI 6/2005

RIGHT BELOW CENTRE

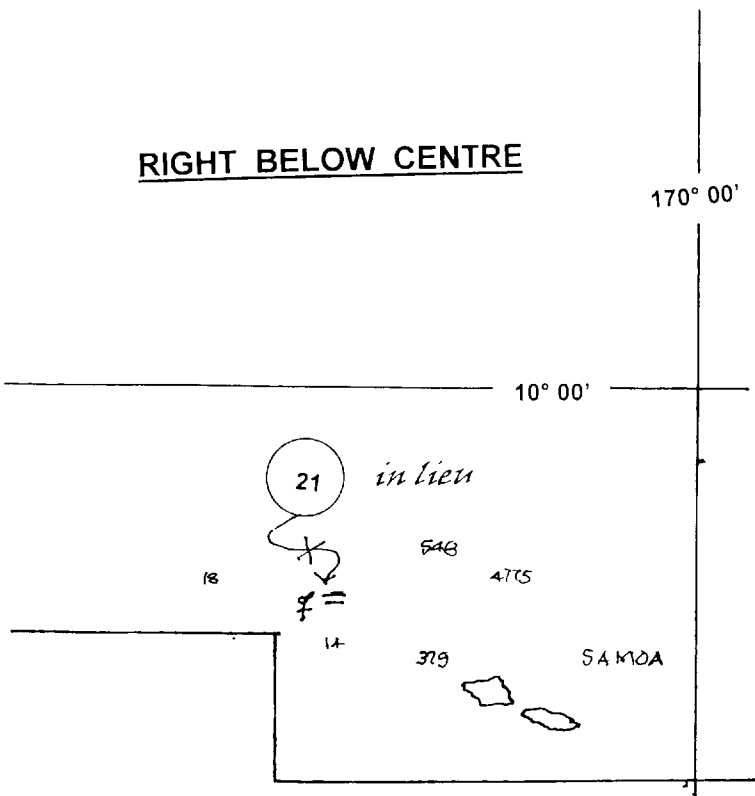

RIGHT ABOVE CENTRE

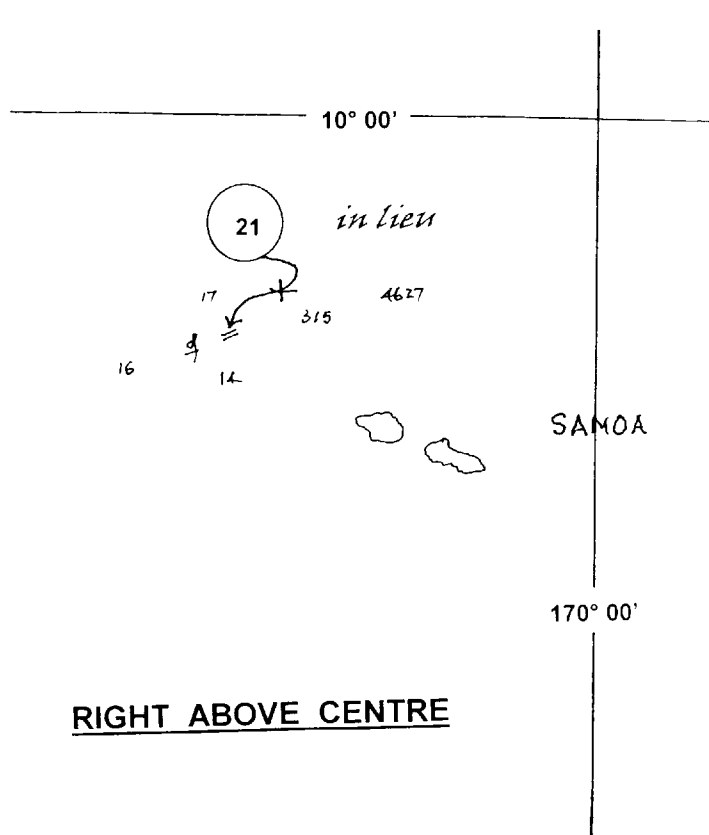

Issued as a guide to chart correction.

Use in conjunction with the appropriate NZ Notice to Mariners.

LAST CORRECTION	NZ NTM No.	CHART No.	LAST CORRECTION	NZ NTM No.	CHART No.
NZ 93/04	NZ 28/05	NZ 14052 (INT 52)	NZ 26/05	NZ 28/05	NZ 14060 (INT 60)

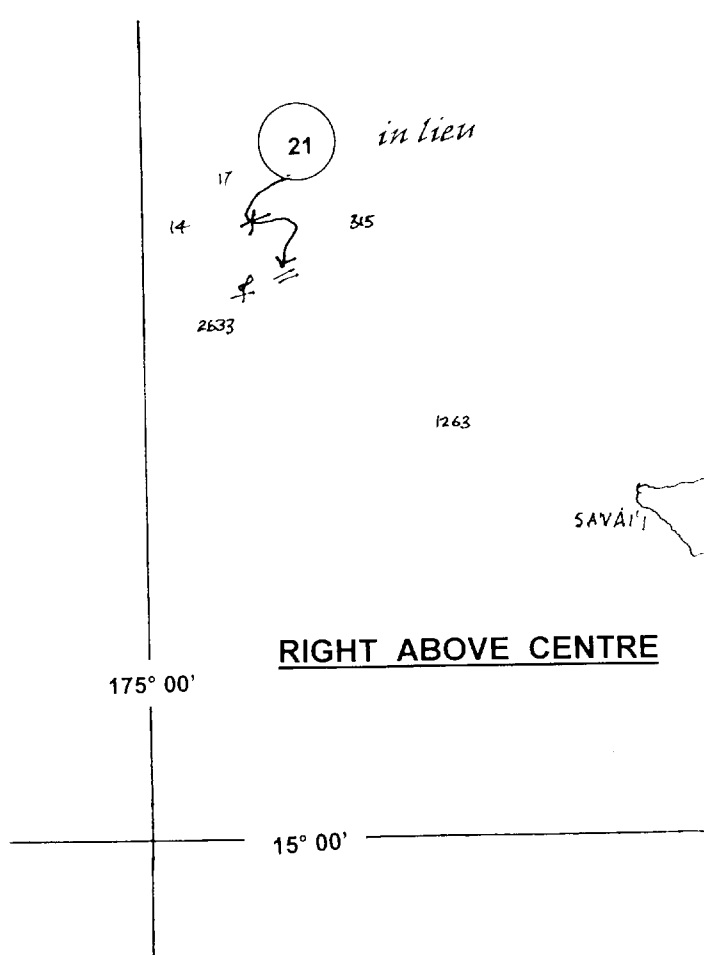
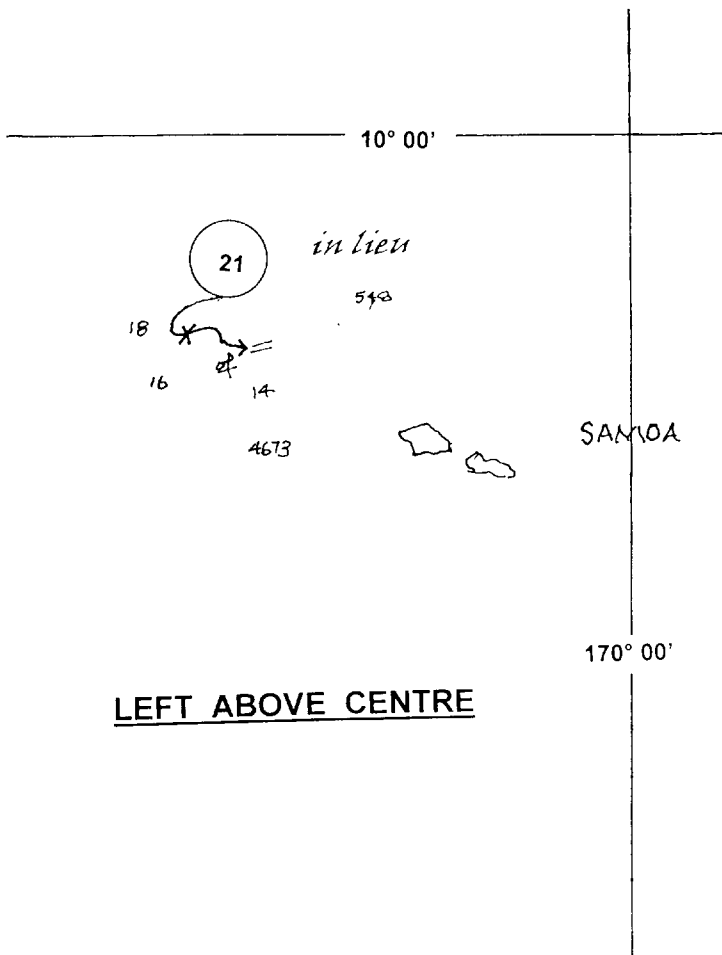

Issued as a guide to chart correction.

Use in conjunction with the appropriate NZ Notice to Mariners.

LAST CORRECTION	NZ NTM No.	CHART No.	LAST CORRECTION	NZ NTM No.	CHART No.
NZ 179/04	NZ 28/05	NZ 14061 (INT 61)	NZ 55/04	NZ 28/05	NZ 14605 (INT 605)

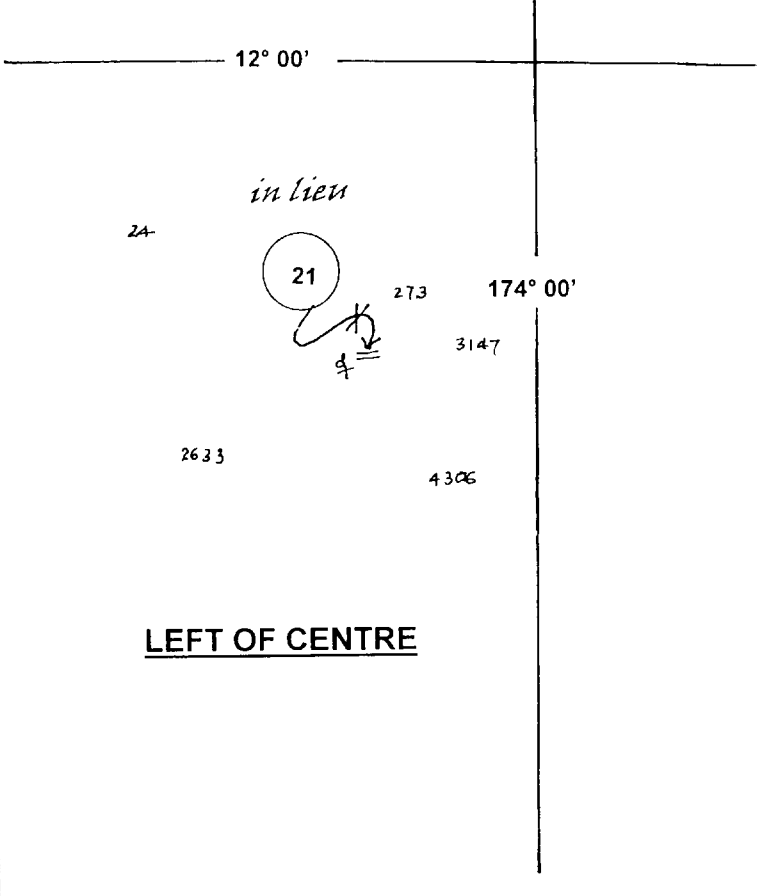
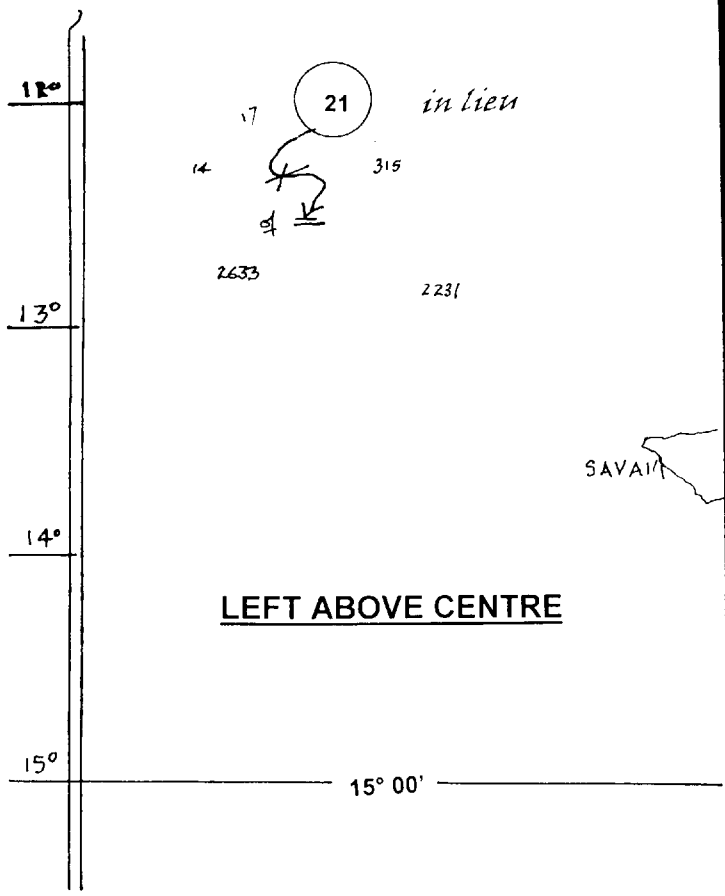

Issued as a guide to chart correction.

Use in conjunction with the appropriate NZ Notice to Mariners.

LAST CORRECTION	NZ NTM No.	CHART No.	LAST CORRECTION	NZ NTM No.	CHART No.
NZ 178/04	NZ 28/05	NZ 14606 (INT 606)	NZ 120/02	NZ 28/05	NZ 14629 (INT 629)

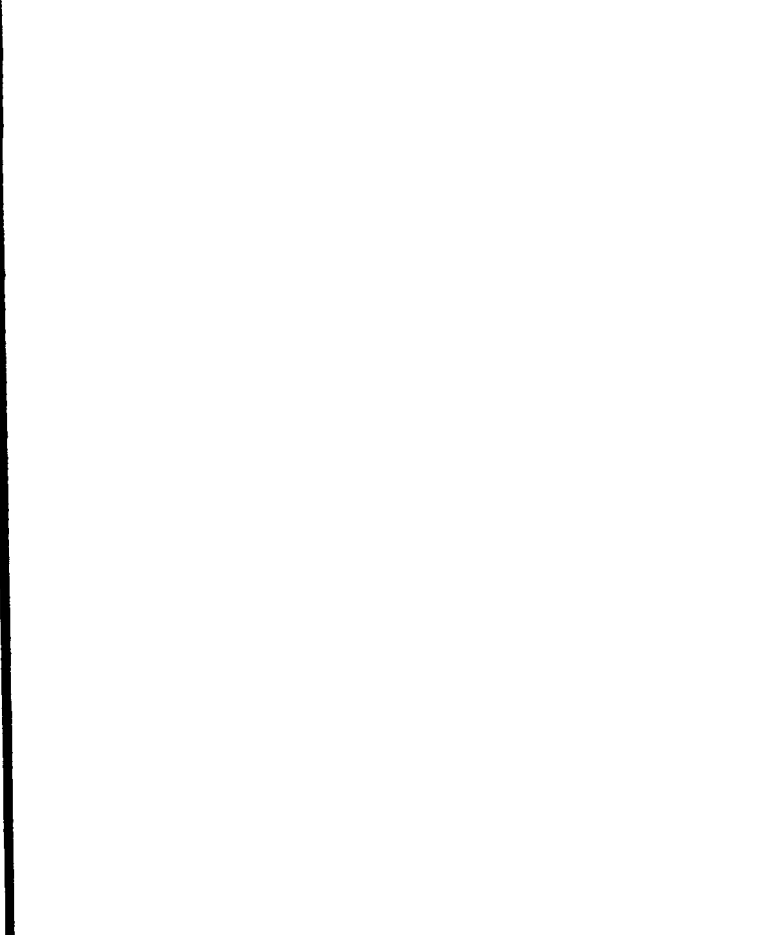
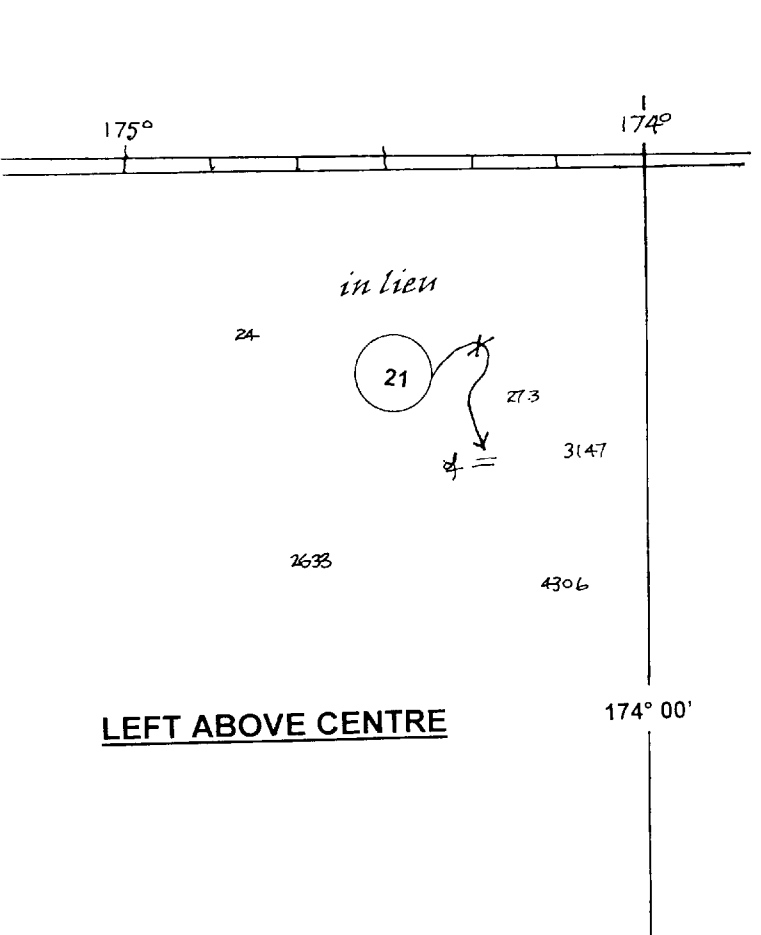

Issued as a guide to chart correction.

Use in conjunction with the appropriate NZ Notice to Mariners.

LAST CORRECTION	NZ NTM No.	CHART No.	LAST CORRECTION	NZ NTM No.	CHART No.
NZ 41/04	NZ 28/05	NZ 14631 (INT 631)			